

# Proteus

WATERPROOFING

Design, Develop, Deliver

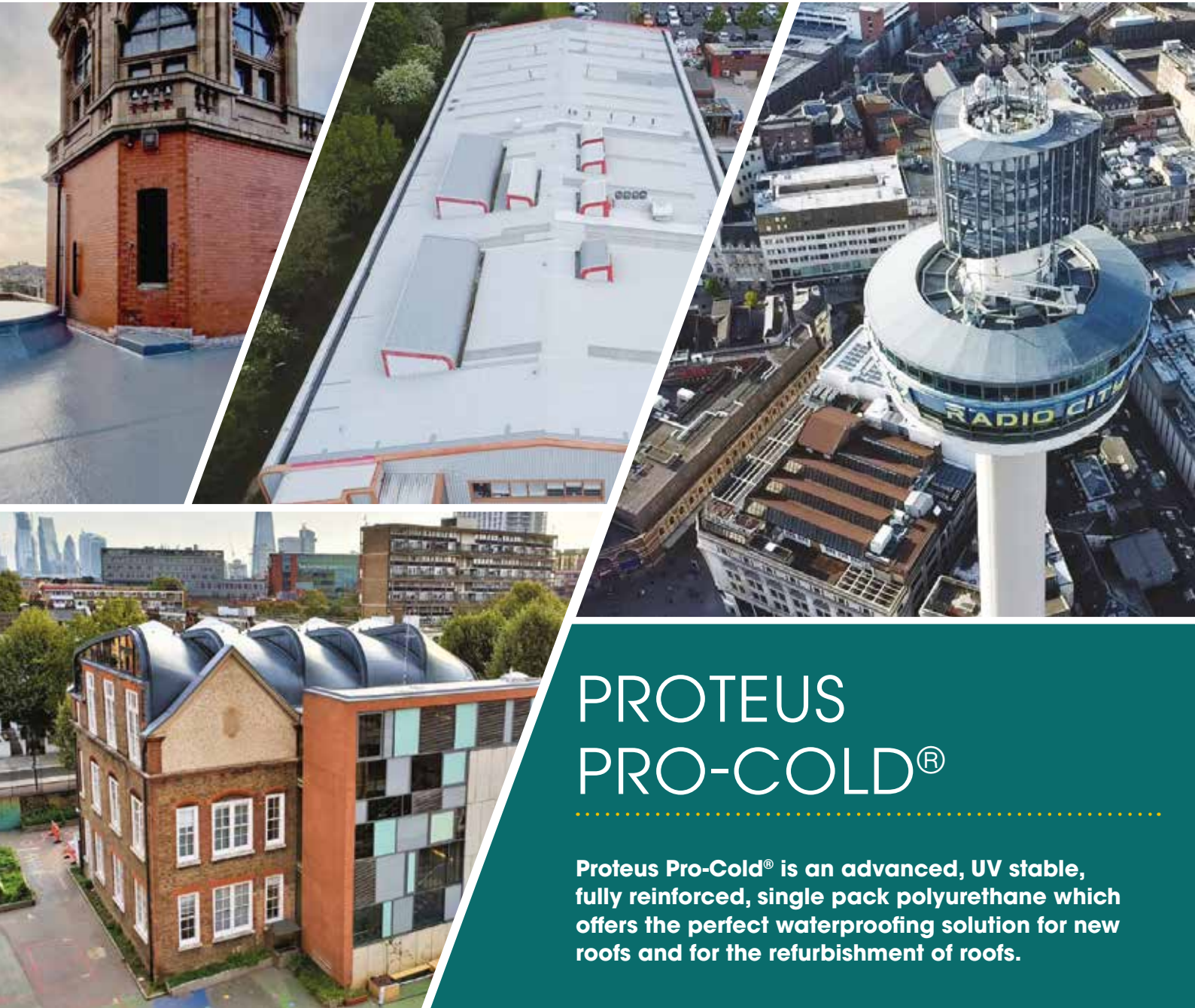

## PROTEUS PRO-COLD®

Proteus Pro-Cold® is an advanced, UV stable, fully reinforced, single pack polyurethane which offers the perfect waterproofing solution for new roofs and for the refurbishment of roofs.



**Proteus Pro-Cold® is our high performance, seamless and cold-applied waterproofing membrane for flat and sloped roofs. The finished product produces a highly engineered seamless waterproof membrane which protects buildings with superb waterproofing performance, durability and UV stability. The product is ideal for both refurbishment overlays and new build projects in conjunction with Proteus Pro-Therm insulation systems. Proteus Pro-Cold® also fully satisfies the requirements of the NHBC standards.**

Proteus Pro-Cold® does not become brittle or discolour with age. It uses atmospheric moisture to trigger its cure process and unlike conventional polyurethane systems can cure under water without gassing or foaming. It is also immediately resistant to rain damage as it is laid and may therefore be applied in relatively poor weather without any subsequent loss of performance or durability.

When subjected to normal service conditions, Proteus Pro-Cold® will provide an effective waterproof barrier for a minimum of 30 years depending on the specification used. All Proteus Pro-Cold® installations can be overcoated at the end of their designed life to extend the roof's guarantee period, therefore reducing costs and the carbon footprint of a new system, plus preventing product going to landfill.

## Applications & Use

Suitable Surfaces:

- ☪ **Concrete and screeds**
- ☪ **Metal**
- ☪ **WBP plywood / Timber**
- ☪ **Existing asphalt**
- ☪ **Existing bituminous felt membranes**
- ☪ **Existing single ply membranes**
- ☪ **Proteus Pro-Therm insulations**

Note: Some surfaces may require priming or sacrificial layers.

Variants:

- ☪ **Protected Built-Up Roof systems**
- ☪ **Warm Built-Up Roof systems**
- ☪ **Cold deck Liquid Applied Membrane**
- ☪ **Warm deck Liquid Applied Membrane**
- ☪ **Gutters Liquid Applied Membrane**
- ☪ **Metal profiled roof sheets protective coating**





Proteus Pro-Cold® is the high performance, seamless and cold-applied waterproofing membrane of choice when a non-disruptive roofing solution is a must. Proteus Pro-Cold® is ideal for a range of applications and offering a number of benefits:

## Benefits

- ☪ *BBA certified for 30 years*
- ☪ *Highest European fire rating BRoofT4 Certification*
- ☪ *Cold applied – eliminating the risk of fire*
- ☪ *Totally seamless*
- ☪ *Elastomeric – does not become brittle with age*
- ☪ *Excellent thermal and UV stability for all climates*
- ☪ *Base and top coats are the same material*
- ☪ *Satisfies the requirements of the NHBC standards 2018*
- ☪ *Good health, safety and environmental performance*
- ☪ *Minimises disruption to other trades and services*
- ☪ *Quick and straightforward application*
- ☪ *From an NFRC and LRWA associate member*

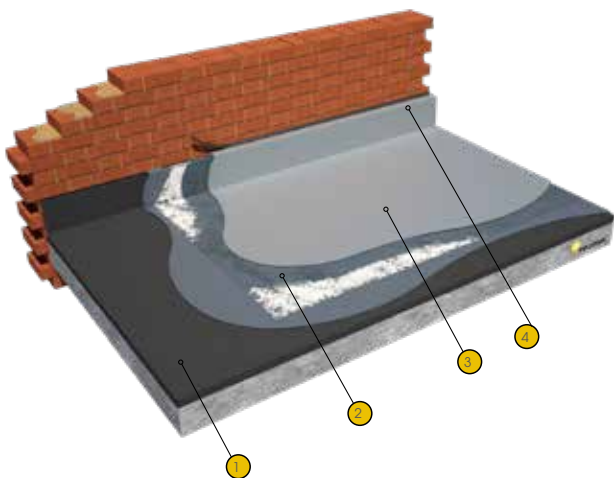

### PROTEUS PRO-COLD®

- 1 Substrate
- 2 Proteus Pro-Cold® Slate Grey Embedment Coat with Pro-Force
- 3 Proteus Pro-Cold® Light Grey Top Coat
- 4 Proteus Sealant

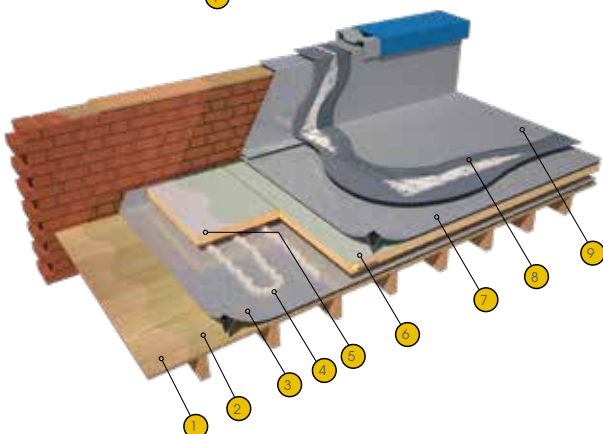

### PROTEUS PRO-COLD® PLUS WARM ROOF

- 1 Substrate
- 2 Pro-Prime® SA
- 3 Pro-Vapour Control SA
- 4 Pro-Bond Foaming
- 5 Proteus Pro-Therm Insulation PIR
- 6 Pro-Prime® SA
- 7 Pro-Carrier Membrane SA
- 8 Proteus Pro-Cold® Slate Grey Embedment Coat with Pro-Force
- 9 Proteus Pro-Cold® Light Grey Top Coat

Call us now on 01268 777871 to find out why Proteus Pro-Cold® is the perfect waterproofing solution for your roof refurbishment.

## Design, Develop, Deliver

Manufactured in the UK and Europe, Proteus Waterproofing is an innovative and fast growing company in the waterproofing market. Proteus Waterproofing is a single source systems supplier, with an array of hot and cold-applied waterproofing and protection systems. The company's comprehensive product range is suitable for high performance roofing, balconies, walkways and car parks. It offers a vast range of systems, that have been engineered to meet the harshest of weather conditions and provide a lasting and robust waterproofing solution, in both refurbishments and new builds.

Experts in all forms of liquid applied and bituminous membrane roofing and waterproofing, Proteus Waterproofing is adaptable to each client's individual needs and circumstances, and offers long-term performance product reliability and a simple installation as standard.

### Total Peace of Mind

Proteus Waterproofing roofing systems are tested to the most rigorous international standards, ensuring they will outperform the initial design life. This will give your project a durable, reliable and long-lasting waterproofing finish, that will last for many years to come, providing excellent value to clients and building owners.

### Guaranteed Performance

Proteus Waterproofing presents clients with a robust choice of guarantees for its bespoke systems, from an offer that also incorporates enhanced independently-backed warranties, for total peace of mind.

For further information, please contact Proteus Waterproofing to discuss the most suitable option to meet your requirements.



#### Proteus Waterproofing Limited

21a Sirdar Road  
Brook Road Industrial Estate  
Rayleigh, Essex SS6 7XF  
T: +44 (0) 1268 777871

Date: 10/25

enquiries@proteuswaterproofing.co.uk  
[www.proteuswaterproofing.co.uk](http://www.proteuswaterproofing.co.uk)

   @Proteus\_UK

Registered Office: Charter House,  
105 Leigh Road, Leigh-On-Sea, Essex, SS9 1JL  
Registered company number: 08458402

#### Proteus Waterproofing's range of lasting and robust systems includes:

- Ⓢ *Liquid applied waterproofing: Cold Melt®, Proteus Pro-Cold®, Proteus Hot Melt®*
- Ⓢ *High performance felts: Proteus Pro-Felt® Ultima Plus, Extra Plus, Endura, Endura AIRdhesive*
- Ⓢ *Balconies and walkways: Pro-BW® Plus, Pro-BW® LO, Cold Melt®*
- Ⓢ *Technical Insulation Design: Proteus Pro-Therm*
- Ⓢ *Coating Protection: Pro-Cryl®*
- Ⓢ *Exterior walls waterproofing: Monosil, Monodex, Monodex Textured*

#### The Proteus Waterproofing Specification includes:

- Ⓢ *On-going technical support*
- Ⓢ *Comprehensive guarantees*
- Ⓢ *Free roof evaluation service*
- Ⓢ *Roof condition surveys, reports, and bespoke specifications*
- Ⓢ *Expert advice on low maintenance solutions*
- Ⓢ *Site survey and design stage involvement*
- Ⓢ *Thermal value calculations to building regulations*
- Ⓢ *Part 'L' Tapered insulation scheme design*
- Ⓢ *Wind uplift calculation*
- Ⓢ *Building regulations Part B (fire) compliance options*

#### The Proteus Waterproofing service package includes:

- Ⓢ *Detailed specifications calculation*
- Ⓢ *National contractor base*
- Ⓢ *Technical manager inspections throughout the project installation and sign off*

