

# Proteus

WATERPROOFING

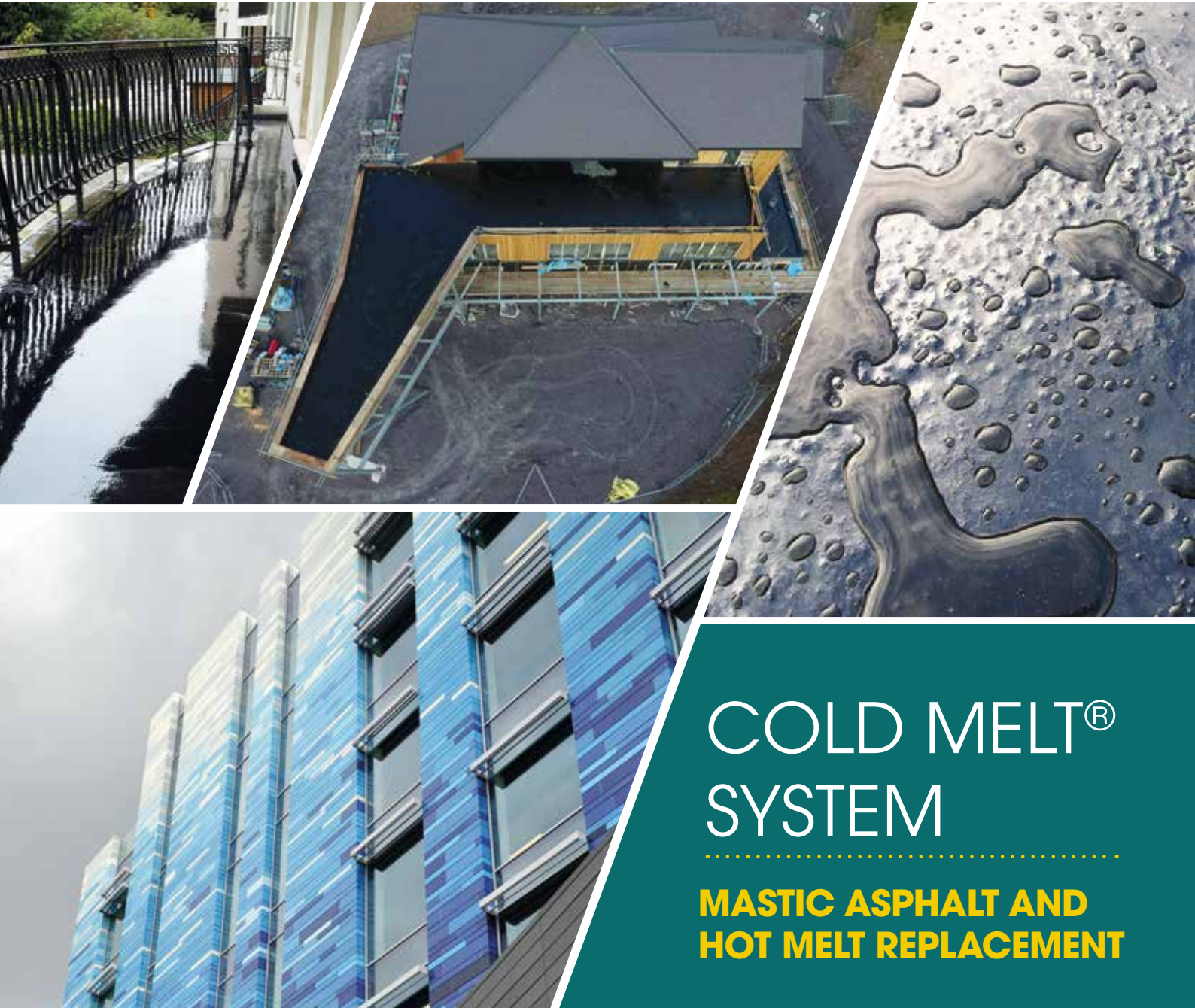

## COLD MELT® SYSTEM

MASTIC ASPHALT AND  
HOT MELT REPLACEMENT



**Design, Develop, Deliver**

## THE MODERN DAY ALTERNATIVE FOR MASTIC ASPHALT AND HOT MELT

### Cold Melt® has it covered

The trademarked Cold Melt® liquid roof system incorporates recycled rubber crumb, castor oil and other organically grown products to create an elastomeric, seamless, cold applied membrane.

Durability – under normal service conditions and when fully protected, the system will provide a durable roof waterproofing for the design life of the roof in which it is incorporated.

It is purpose-made to be an integral component of green and brown roof systems and, with its unparalleled seamless cold-applied waterproof finish, is quick, simple and safe to apply.

The Cold Melt® system can include inverted roof insulation and, with or without insulation, can be designed as a paved, ballasted, green or brown roof. The membrane does not become brittle with age.

An Agrément Certificate relates to the Proteus Cold Melt® System for use as a waterproofing layer in inverted roofs and protected flat roofs, including zero pitched roofs.

### Benefits

- *No odour*
- *Cold-applied*
- *Seamless, monolithic bond*
- *Elastomeric*
- *Incorporates recycled rubber crumb and other organically grown product*
- *Does not become brittle with age*
- *Cost-effective*
- *Fast to install*
- *Flexible solution around combusting high detail items such as plastic pipes, PVC windows & doors and awkward details etc.*
- *BBA certified for the life of the building*
- *Can be laid on a flat roof deck with zero falls*

### No Odour

Cold Melt® exhibits no odour offering numerous benefits for both the installer and client due to it being 100% solids.





## A wide range of inverted roof decks

Cold Melt® is a cold-applied two-part elastomeric waterproofing membrane that provides seamless roof protection.

- Concrete
- Asphalt
- Timber/Plywood

### Cold Melt® Inverted build-up

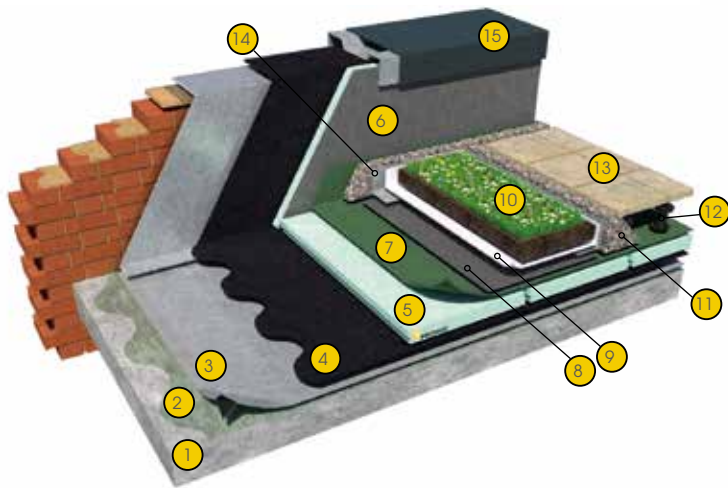

- |                                      |   |
|--------------------------------------|---|
| 1 Deck                               | 10 Proteus Pro-Living® Pre-Cultivated Green Roof Covering |
| 2 Pro-Prime® SA                      | 11 Washed Rounded Ballast                                 |
| 3 Pro-Carrier SA                     | 12 Proteus Pedestal                                       |
| 4 Cold Melt®                         | 13 Hard Landscaping / Paving                              |
| 5 Proteus Pro-Therm XPS              | 14 Proteus Pro-Living® Drainage Trim                      |
| 6 Proteus Cement Topped XPS          | 15 Metal Capping  |
| 7 Proteus Low-K Water Reducing Layer |   |
| 8 Proteus Pro-Living® Drainage Layer |   |
| 9 Proteus Pro-Living® Filter Fleece  |   |

### Cold Melt® Warm roof build up

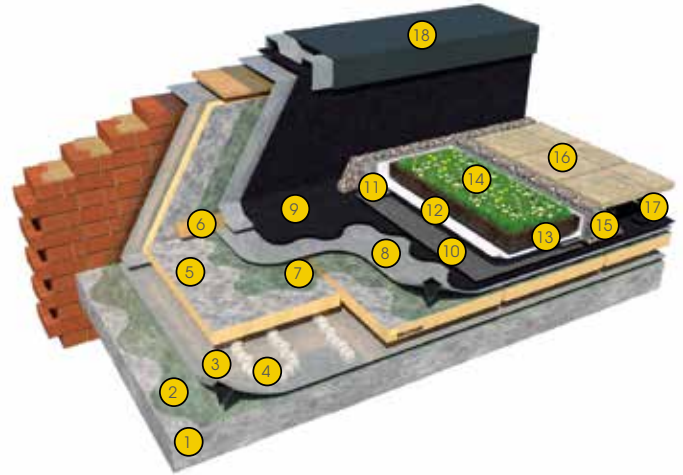

- |                               |   |
|-------------------------------|---|
| 1 Deck/Substrate              | 11 Drainage Trim  |
| 2 Pro-Prime® SA               | 12 Pro-Living® Filter Fleece                                      |
| 3 Pro-Vapour Control          | 13 Growing Medium   |
| 4 Pro-Bond Foaming            | 14 Pro-Living® Sedum/ Wildflower                                  |
| 5 Proteus Pro-Therm PIR       | 15 20-40 Wash Cobbles   |
| 6 Angle Fillet                | 16 Spartan Tiles  |
| 7 Pro-Prime® SA               | 17 Proteus Pro-Pedestal Self-Levelling Adjustable Paving Pedestal |
| 8 Pro-Carrier Membrane        | 18 Coping System  |
| 9 Cold Melt®                  |   |
| 10 Pro-Living® Drainage Layer |   |

## Green and Warm Roof Construction

Cold Melt® Built-Up Roof system can be installed as a warm roof using a range of conventional insulations such as Proteus Pro-Therm PIR and other innovative insulations. This allows for reductions in the thickness of the insulation while still maintaining all current regulations, an essential in refurbishment situations where existing upstand and threshold heights are set – or where the roof design features low upstand/threshold heights.

Once the Cold Melt® System is in place, a Proteus Pro-Living® Green roof or other finish can be installed, paved, stone ballast or decked finish. The system is compatible with a wide range of roof decks and existing roof surface finishes including Metal, Timber, Concrete, Asphalt and Felt.

### BBA Cold Melt® Durability Statement

Under normal service conditions and when fully protected, the system will provide a durable roof for the design life of the roof in which it is incorporated.

### NHBC Standards 2016

NHBC accepts the use of Proteus Cold Melt®

### Cold Melt® Root Test

Cold Melt® is Root Tested to the German 2 year test EN13948:2007 allowing it to be designed for use under Extensive and Intensive Roof Gardens. For more information please refer to the Proteus Pro-Living® Green roof brochure – available as a download at [www.proteuswaterproofing.co.uk](http://www.proteuswaterproofing.co.uk)



# Proteus

**WATERPROOFING**

## Design, Develop, Deliver

Manufactured in the UK and Europe, Proteus Waterproofing is an innovative and fast growing company in the waterproofing market. Proteus Waterproofing is a single source systems supplier, with an array of hot and cold-applied waterproofing and protection systems. The company's comprehensive product range is suitable for high performance roofing, balconies, walkways and car parks. It offers a vast range of systems, that have been engineered to meet the harshest of weather conditions and provide a lasting and robust waterproofing solution, in both refurbishments and new builds.

Experts in all forms of liquid applied and bituminous membrane roofing and waterproofing, Proteus Waterproofing is adaptable to each client's individual needs and circumstances, and offers long-term performance product reliability and a simple installation as standard.

## Total Peace of Mind

Proteus Waterproofing roofing systems are tested to the most rigorous international standards, ensuring they will outperform the initial design life. This will give your project a durable, reliable and long-lasting waterproofing finish, that will last for many years to come, providing excellent value to clients and building owners.

## Guaranteed Performance

Proteus Waterproofing presents clients with a robust choice of guarantees for its bespoke systems, from an offer that also incorporates enhanced independently-backed warranties, for total peace of mind.

For further information, please contact Proteus Waterproofing to discuss the most suitable option to meet your requirements.



### Proteus Waterproofing Limited

21a Sirdar Road  
Brook Road Industrial Estate  
Rayleigh, Essex SS6 7XF  
T: +44 (0) 1268 777871

Date: 10/25

### Proteus Waterproofing's range of lasting and robust systems includes:

- ❧ *Liquid applied waterproofing: Cold Melt®, Proteus Pro-Cold®, Proteus Hot Melt®*
- ❧ *High performance felts: Proteus Pro-Felt® Ultima Plus, Extra Plus, Endura, Endura AIRdhesive*
- ❧ *Balconies and walkways: Pro-BW® Plus, Pro-BW® LO, Cold Melt®*
- ❧ *Technical Insulation Design: Proteus Pro-Therm*
- ❧ *Coating Protection: Pro-Cryl®*
- ❧ *Exterior walls waterproofing; Monosil, Monodex, Monodex Textured*

### The Proteus Waterproofing Specification includes:

- ❧ *On-going technical support*
- ❧ *Comprehensive guarantees*
- ❧ *Free roof evaluation service*
- ❧ *Roof condition surveys, reports, and bespoke specifications*
- ❧ *Expert advice on low maintenance solutions*
- ❧ *Site survey and design stage involvement*
- ❧ *Thermal value calculations to building regulations*
- ❧ *Part 'L' Tapered insulation scheme design*
- ❧ *Wind uplift calculation*
- ❧ *Building regulations Part B (fire) compliance options*

### The Proteus Waterproofing service package includes:

- ❧ *Detailed specifications calculation*
- ❧ *National contractor base*
- ❧ *Technical manager inspections throughout the project installation and sign off*

enquiries@proteuswaterproofing.co.uk  
**www.proteuswaterproofing.co.uk**

   @Proteus\_UK

Registered Office: Charter House,  
105 Leigh Road, Leigh-On-Sea, Essex, SS9 1JL  
Registered company number: 08458402

