



Proteus

WATERPROOFING



SOLUTIONS FOR
BALCONIES
AND WALKWAYS

CAN BE
REFURBISHED
IN JUST
TWO HOURS





**CAN BE
REFURBISHED
IN JUST
TWO HOURS**

BALCONIES & WALKWAYS

Introducing an advanced range of Balcony and Walkway systems from Proteus, one of the most innovative, growing companies in the liquid waterproofing market. Our cold applied systems – especially developed to cause minimum disruption to tenants and residents – are setting new standards in quality and efficiency that few can match.

As well as waterproofing, our systems include concrete repair and exterior wall coatings, all supported by extensive insurance backed guarantees – if required – making us the single source systems provider for local authorities, housing associations and those in the private sector responsible for public areas.

The Proteus range of waterproofing and coating systems are manufactured to meet almost every type of design or construction application.

Contents

Page 4
Pro-BW® Plus

Page 5
Cold Melt®

Page 6
Zip World

Page 7
Monosil, Monodex and
Monodex Textured

Page 8
Guarantees

Building Envelope Protection

- Pro-BW® Plus – balconies/terraces and podium decks waterproofing
- Concrete repairs to soffits and undersides of balconies
- Monodex Smooth applied to underside of balconies
- Monosil applied to structural walls to protect porous brickwork
- Cold Melt® – covered balconies/terraces and podium decks waterproofing
- Insurance backed guarantees available



A flexible waterproofing system that can withstand building and thermal movement and is ideal for balconies over liveable accommodation

Pro-BW® Plus is a high performance, rapid curing protective waterproofing membrane for balconies and walkways. Ideal for refurbishment where structural movement has occurred or is anticipated. Pro-BW® Plus reduces installation time from days to hours.

Suitable for a variety of external applications, Pro-BW® Plus can be installed on concrete, asphalt and wooden substrates for communal and private balconies, walkways, staircases and pedestrian ramps. As it is a cold applied installation, the system meets health and safety criteria by minimising risk to both operatives and members of the public.

As well as offering excellent UV and chemical resistance to ensure outstanding long term performance, Pro-BW® Plus also offers a wide range of life expectancy options. Pro-BW® Plus incorporates aggregates to provide a slip-resistant seamless finish yet still providing a surface that is easily cleaned, in a range of colours.

Benefits

- Minimal disruption
- Rapid cure times
- Effective for awkward details
- Flexible with a high level of tensile strength
- Skid-inhibiting when aggregates applied
- Durable, up to 20 years to first major maintenance
- Wide range of substrate applications

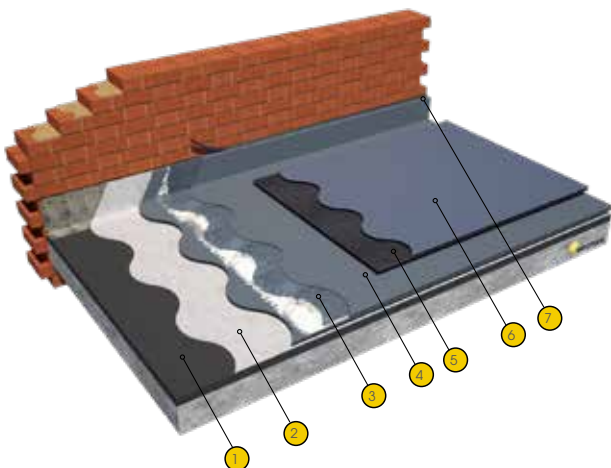

- 1 Substrate
- 2 Pro-BW® Primer
- 3 Pro-BW® Plus Embedment Coat with Pro-Force 450

- 4 Pro-BW® Plus Resin Top Coat
- 5 Pro-BW® Plus Resin & Pro-Aggregate EM
- 6 Pro-BW® Plus Sealer
- 7 Proteus Sealant



COLD MELT®

Benefits

- Virtually no odour
- Cold-applied
- Seamless, monolithic bond
- Elastomeric
- Incorporates recycled rubber crumb and other organically grown product
- Does not become brittle with age
- Cost-effective
- Fast to install
- Flexible solution around combusting high detail items such as plastic pipes, PVC windows & doors and awkward details etc.
- BBA certified for the life of the structure
- Can be laid on a flat roof deck with zero falls

The solution for covered walkways and balconies

Ideal for new build and refurbishment, Cold Melt® is a cold-applied, two-part elastomeric waterproofing membrane that provides seamless roof protection for concrete, asphalt, wood and other substrates. Cold Melt® can be covered with many finishes including screed, brick, tile, concrete, wood decking and even a green roof.

Setting new standards in quality and efficiency that few can match, the cold-applied Cold Melt® waterproofing system offers a fast cure time, is no odour and has been specifically developed to cause minimum disruption, making it the perfect solution for confined walkways and balconies.

Saving time and money, this proven waterproofing solution can easily be applied around intricate detailing and will ensure walkways and balconies will be watertight for years to come.

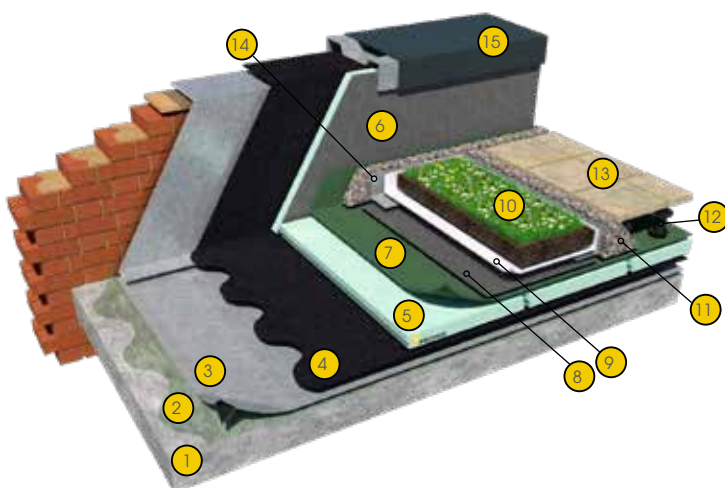

- | | |
|--------------------------------------|---|
| 1 Deck | 10 Proteus Pro-Living® Pre-Cultivated Green Roof Covering |
| 2 Pro-Prime® SA | 11 Washed Rounded Ballast |
| 3 Pro-Carrier SA | 12 Proteus Pedestal |
| 4 Cold Melt® | 13 Hard Landscaping / Paving |
| 5 Proteus Pro-Therm XPS | 14 Proteus Pro-Living® Drainage Trim |
| 6 Proteus Cement Topped XPS | 15 Metal Capping |
| 7 Proteus Low-K Water Reducing Layer | |
| 8 Proteus Pro-Living® Drainage Layer | |
| 9 Proteus Pro-Living® Filter Fleece | |



COLD MELT® ZIP WORLD, BANGOR

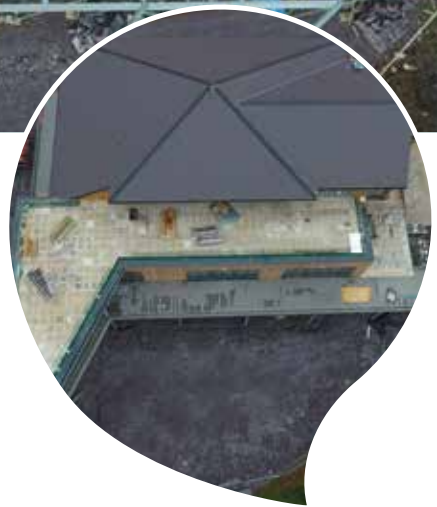

Proteus Waterproofing's Cold Melt® system provides a fast and efficient installation for long term, all-weather protection as can be seen below with the new build terrace roof project at Zip World, Bangor.

In a spectacular corner of North Wales and close to Snowdonia National Park, Zip World at Penrhyn Quarry features the fastest zip wire in the world and is the UK's scariest new attraction. As part of the new visitor experience centre, built in what was once the biggest quarry in the world, the contractor required an easy to install roofing system which would provide proven and long term protection against the worst of the severe weather.

Applied by the Proteus Approved Contractor, 350m² of Cold Melt® seamless waterproofing was selected to protect the roof terrace and provide a fast and efficient installation so work could be carried out below.

Key Requirements: High Performance Waterproofing

This new build project was constructed with a concrete deck, but as waterproofing work was carried out in Snowdonia in November, the concrete had no chance to dry out which would normally prevent a waterproof system being installed. The problem was overcome by first applying the Proteus DPM primer to the deck which can be installed over 98% saturated concrete and then cures to form a barrier to moisture so that the Proteus Cold Melt® waterproofing system can be installed.

This was followed by the Proteus Pro-Carrier SA, the first layer of the waterproofing system, a stand-alone, self-adhesive metal lined vapour barrier, which once installed ensured the building was watertight. This was essential as the winter weather closed in on the property preventing the application of the Cold Melt® resin membrane. The roofing contractor was able to pull off site until March when the weather improved.

However, the main contractor was able to continue working inside the property, in the dry, ensuring the build program remained on track. On returning in March the licensed roofing contractor continued the system, installing the Cold Melt® resin, Proteus Pro-Therm XPS insulation and finishing off the roof with concrete pavers.

Key Requirements: Quality Control

Proteus Waterproofing worked in close partnership with licensed contractor to successfully deliver the project to a very high standard. The inverted roof system incorporated a Pro Carrier SA, Pro Prime® SA underlay film and Proteus Pro Therm XPS 50mm insulation. A Cold Melt® UV Top coat was applied to any exposed surfaces remaining to protect from the sun.

Key Requirements: Seamless Waterproofing

Incorporating recycled rubber-crumb and other organically grown products, Cold Melt® creates an elastomeric, seamless, cold applied membrane.



Wall
Decoration
and
Protection

MONOSIL, MONODEX & MONODEX TEXTURED

Monosil for concrete, brick and stone

Monosil is a clear masonry impregnator which stops the ingress of rain but at the same time does not block the surface pores of the structure. It allows entrapped moisture to be warmed by the sun, turn to vapour and pass out of the structure over a period of time, enabling it to dry out.

Benefits

- Waterproof, long term decorative finish
- Breathable protection for walls
- Elastomeric properties for crack bridging
- Minimises maintenance
- Does not flake/brittle with age
- Conventionally applied by brush or roller

Monosil is invisible to the eye so does not alter the look of the building. It helps to prevent absorption of oils and other liquid contamination allowing for easier removal of contaminants.

Monodex Smooth – water-based elastomeric decorative coating

Monodex Smooth is a high performance water based, elastomeric, high build, decorative coating which provides protection against carbonation and water ingress, yet allows damp substrates to breathe. It is ultra-fast drying which enables two coat applications to take place on the same day and facilitates year round usage.

It resists the growth of mould and fungi and is ideal both for new construction and refurbishment projects.

Monodex Textured – high performance, flexible waterborne textured coating

Monodex Textured is a highly engineered, waterborne, single component, acrylic-based decorative wall coating with an attractive textured finish. Due to its high build, textured composition, it is ideal for use on buildings and other structures which have a rough, uneven finish with surface defects and imperfections.

Manufactured in the UK and Europe, Proteus Waterproofing is one of the most innovative, fast growing companies in the waterproofing market. Proteus Waterproofing is a single source systems supplier, with an array of hot and cold-applied waterproofing and protection systems. The company's comprehensive product range is suitable for high performance roofing, balconies, walkways and car parks. It offers a vast range of systems, that have been engineered to meet the harshest of weather conditions and provide a lasting and robust waterproofing solution, in both refurbishments and new builds.

Experts in all forms of liquid applied and bituminous membrane roofing and waterproofing, Proteus Waterproofing is adaptable to each client's individual needs and circumstances, and offers long-term performance product reliability and a simple installation as standard.

Total Peace of Mind

Proteus Waterproofing roofing systems are tested to the most rigorous international standards, ensuring they will outperform the initial design life. This will give your project a durable, reliable and long-lasting waterproofing finish, that will last for many years to come, providing excellent value to clients and building owners.

Guaranteed Performance

Proteus Waterproofing presents clients with a robust choice of guarantees for its bespoke systems, from an offer that also incorporates enhanced independently-backed warranties, for total peace of mind.

For further information, please contact Proteus Waterproofing to discuss the most suitable option to meet your requirements.

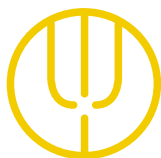

Proteus Waterproofing Limited

21a Sirdar Road
Brook Road Industrial Estate
Rayleigh, Essex SS6 7XF
T: +44 (0) 1268 777871

Date: 04/22

enquiries@proteuswaterproofing.co.uk
www.proteuswaterproofing.co.uk

 @Proteus_UK

Registered Office: Charter House,
105 Leigh Road, Leigh-On-Sea, Essex, SS9 1JL
Registered company number: 08458402

Proteus Waterproofing's range of lasting and robust systems includes:

- *Liquid-applied waterproofing: Proteus Pro-System® Plus*
- *Inverted roof waterproofing: Cold Melt®, Proteus Hot Melt®*
- *High performance felts: Proteus Pro-Felt®, Ultima, Ultima Plus, Extra, Extra Plus*
- *Balconies and walkways: Pro-BW® Plus, Cold Melt®*
- *Car park decking systems: Deckmaster*
- *Coating protection: Pro-Cryl®, Pro-Solar Reflect*
- *Exterior walls waterproofing: Monosil, Monodex & Monodex Textured*

The Proteus Waterproofing Specification includes:

- *On-going technical support*
- *Comprehensive guarantees*
- *Free roof evaluations service*
- *Roof condition surveys, reports and bespoke specifications*
- *Expert advice on low maintenance solutions*
- *Site survey and design stage involvement*
- *Thermal value calculations to building regulations part 'L'*
- *Tapered insulation scheme design*
- *Wind uplift calculation*
- *Building regulations Part B (fire) compliance options*

The Proteus Waterproofing service package includes:

- *Detailed specifications*
- *National contractor base*
- *Technical manager inspections throughout the project*
- *Installation sign off*

