



Proteus

Waterproofing



PROTEUS PRO-SYSTEM[®] PLUS

Proteus Pro-System[®] Plus is an advanced, UV stable, fully reinforced, asphaltic polyurethane system which offers the perfect waterproofing solution for the refurbishment of roofs



Proteus Pro-System® Plus is our market leading premium, high performance, seamless and cold-applied waterproofing membrane for flat and sloped roofs. The finished product produces a highly engineered seamless waterproof membrane which protects buildings with superb waterproofing performance, durability and UV stability. The product is ideal for both refurbishment overlays and new build projects in conjunction with Proteus Pro-Therm insulation systems. Proteus Pro-System® Plus also fully satisfies the requirements of the NHBC standards.

Proteus Pro-System® Plus does not become brittle, wear away or discolour with age. It uses atmospheric moisture to trigger its cure process and unlike conventional polyurethane systems can cure under water without gassing or foaming. It is also immediately resistant to rain damage as it is laid and may therefore be applied in relatively poor weather without any subsequent loss of performance or durability.

When subjected to normal service conditions, Proteus Pro-System® Plus will provide an effective waterproof barrier for 25 or 30 years depending on the specification used. All Proteus Pro-System® Plus installations can be overcoated at the end of their designed life to extend the roof's guarantee period, therefore reducing costs and the carbon footprint of a new system, plus preventing product going to landfill.

Applications

- *Primed concrete decks*
- *Bituminous felt sanded and mineral*
- *Mastic asphalt*
- *Timber decks (with Pro-Carrier SA membrane)*
- *Full BUR (built up, insulated roof system – cold installation for all components)*
- *Metal gutters*
- *Lead and other metal*
- *Metal cladding*
- *Asbestos*
- *Single-ply membranes (subject to adhesion test)*



Proteus Pro-System® Plus is the high performance, seamless and cold-applied waterproofing membrane of choice when a non-disruptive roofing solution is a must. Proteus Pro-System® Plus is a low odour application making it ideal for a range of applications and offering a number of benefits:

Benefits

- Premium product
- BBA certified for 30 years
- Highest European fire rating B Roof T4 Certification
- Extremely Low odour
- Cold applied – eliminating the risk of fire
- Totally seamless
- Elastomeric – does not become brittle with age
- Excellent thermal and UV stability for all climates
- Base and top coats are the same material
- Satisfies the requirements of the NHBC standards 2018
- Market Leading” Health, safety and environmental performance
- Can be applied on sensitive live sites, i.e hospitals and schools
- Minimises disruption to other trades and services
- Can be applied in confined spaces
- Quick and straightforward application
- Anti-slip tested
- From an NFRC Associate Member

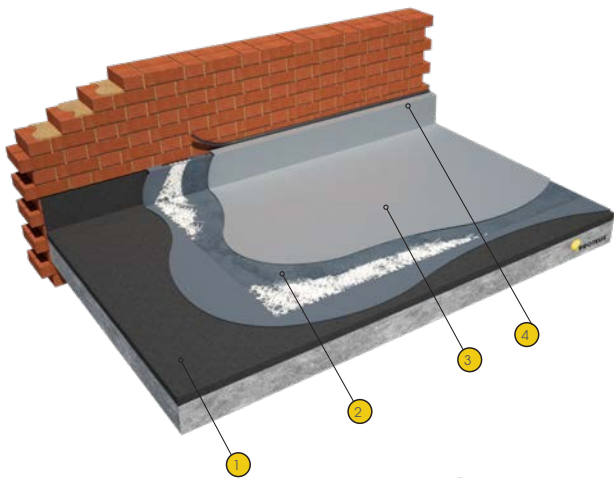

PROTEUS PRO-SYSTEM® PLUS

- | | |
|---|--|
| 1 Substrate | Pro-Force |
| 2 Proteus Pro-System® Plus Mid Grey Embedment Coat with | 3 Proteus Pro-System® Plus Light Grey Top Coat |
| | 4 Proteus Sealant |

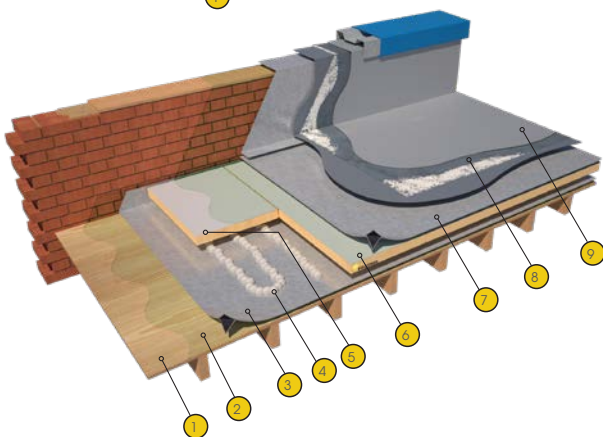

PROTEUS PRO-SYSTEM® PLUS WARM ROOF

- | | |
|------------------------------------|---|
| 1 Substrate | 7 Pro-Carrier Membrane SA |
| 2 Pro-Prime® SA | 8 Proteus Pro-System® Plus Mid Grey Embedment Coat with Pro-Force |
| 3 Pro-Vapour Control SA | 9 Proteus Pro-System® Plus Light Grey Top Coat |
| 4 Pro-Bond Foaming | |
| 5 Proteus Pro-Therm Insulation PIR | |
| 6 Pro-Prime® SA | |

Call us now on 01268 777871 to find out why Proteus Pro-System® Plus is the perfect waterproofing solution for your roof refurbishment.



Proteus Waterproofing

Manufactured in the UK and Europe, Proteus Waterproofing is one of the most innovative, fast growing companies in the waterproofing market. Proteus Waterproofing is a single source systems supplier, with an array of hot and cold-applied waterproofing and protection systems. The company's comprehensive product range is suitable for high performance roofing, balconies, walkways and car parks. It offers a vast range of systems, that have been engineered to meet the harshest of weather conditions and provide a lasting and robust waterproofing solution, in both refurbishments and new builds.

Experts in all forms of liquid applied and bituminous membrane roofing and waterproofing. Proteus Waterproofing is adaptable to each client's individual needs and circumstances, and offers long-term performance product reliability and a simple installation as standard.

Total Peace of Mind

Proteus Waterproofing roofing systems are tested to the most rigorous international standards, ensuring they will outperform the initial design life. This will give your project a durable, reliable and long-lasting waterproofing finish, that will last for many years to come, providing excellent value to clients and building owners.

Guaranteed Performance

Proteus Waterproofing presents clients with a robust choice of guarantees for its bespoke systems, from an offer that also incorporates enhanced independently-backed warranties, for total peace of mind.

For further information, please contact Proteus Waterproofing to discuss the most suitable option to meet your requirements.



Proteus Waterproofing Limited

21a Sirdar Road, Brook Road Industrial Estate, Rayleigh, Essex SS6 7XF
T: +44 (0) 1268 777871

Date: 04/21

enquiries@proteuswaterproofing.co.uk
www.proteuswaterproofing.co.uk

 @Proteus_UK

Registered Office: Charter House,
105 Leigh Road, Leigh-On-Sea, Essex, SS9 1JL
Registered company number: 08458402

Proteus Waterproofing's range of lasting and robust systems includes:

- *Liquid-applied waterproofing: Proteus Pro-System® Plus*
- *Inverted roof waterproofing: Cold Melt®, Proteus Hot Melt®*
- *High performance felts: Proteus Pro-Felt®, Ultima, Ultima Plus, Extra, Extra Plus*
- *Balconies and walkways: Pro-BW® Plus, Cold Melt®*
- *Car park decking systems: Deckmaster*
- *Coating protection: Pro-Cryl®, Pro-Solar Reflect*
- *Exterior walls waterproofing: Monosil, Monodex & Monodex Textured*

The Proteus Waterproofing Specification includes:

- *On-going technical support*
- *Comprehensive guarantees*
- *Free roof evaluations service*
- *Roof condition surveys, reports and bespoke specifications*
- *Expert advice on low maintenance solutions*
- *Site survey and design stage involvement*
- *Thermal value calculations to building regulations part 'L'*
- *Tapered insulation scheme design*
- *Wind uplift calculation*
- *Building regulations Part B (fire) compliance options*

The Proteus Waterproofing service package includes:

- *Detailed specifications*
- *National contractor base*
- *Technical manager inspections throughout the project*
- *Installation sign off*

